

EQ6 EXTENTION TUBE ASSEMBLY

Fig.1

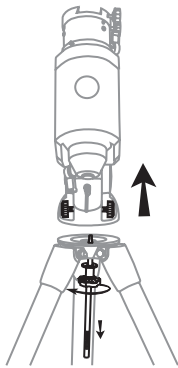

1) Safely remove the mount from the tripod by unscrewing the primary locking shaft underneath until it is loosen.

2) Remove the metal dowel from the tripod head.

Fig.2

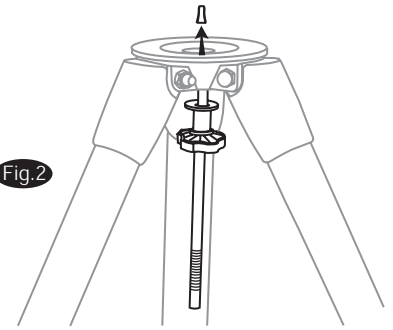
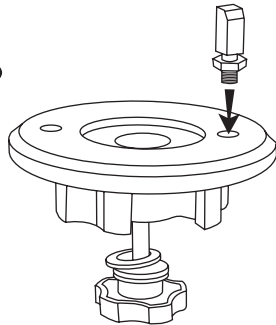

Fig.3



3) Locate mount base and position the metal dowel in either one of the screw holes.

4) Align the mount base beneath the EQ6 mount between the Azimuth Adjustment knobs and push the mount base up against the EQ6 mount and turn the kurlted knob to lock them in place.

Fig.4

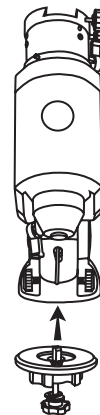
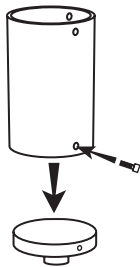

Fig.5



5) Locate EQ6 Extension Tube and place it over the locking disc with plateau surface facing down. Secure with alignment screws from the bottom opening of EQ6 Extension Tube with the locking disc in place.

Fig.6

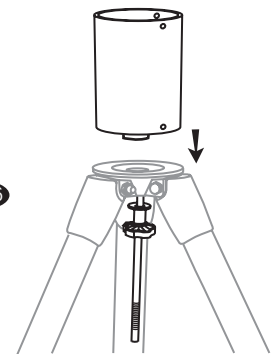
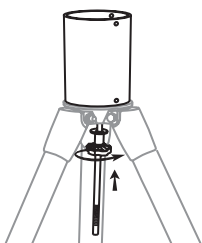

Fig.7



6) Place the assembly from step 5 above the tripod head.

7) Push the primary locking shaft up against the EQ6 Extension Tube assembly and turn the kurlted knob underneath to secure it in place.

Fig.8

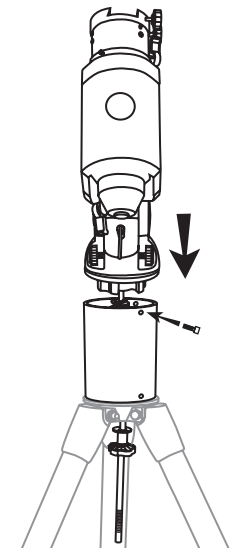
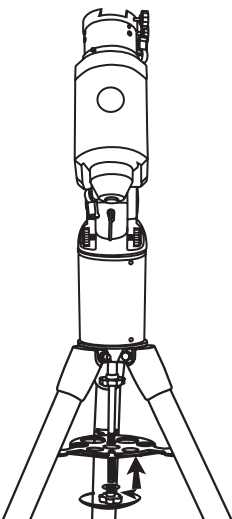

Fig.9



8) Lower the EQ6 mount onto the Extention Tube Assembly then rotate the mount until the 3 top screw holes are visible. Align and secure with alignment screws.

9) Slide the accessory tray along the primary locking shaft until it pushes against all 3 tripod legs. Secure with the washer and locking knob.